

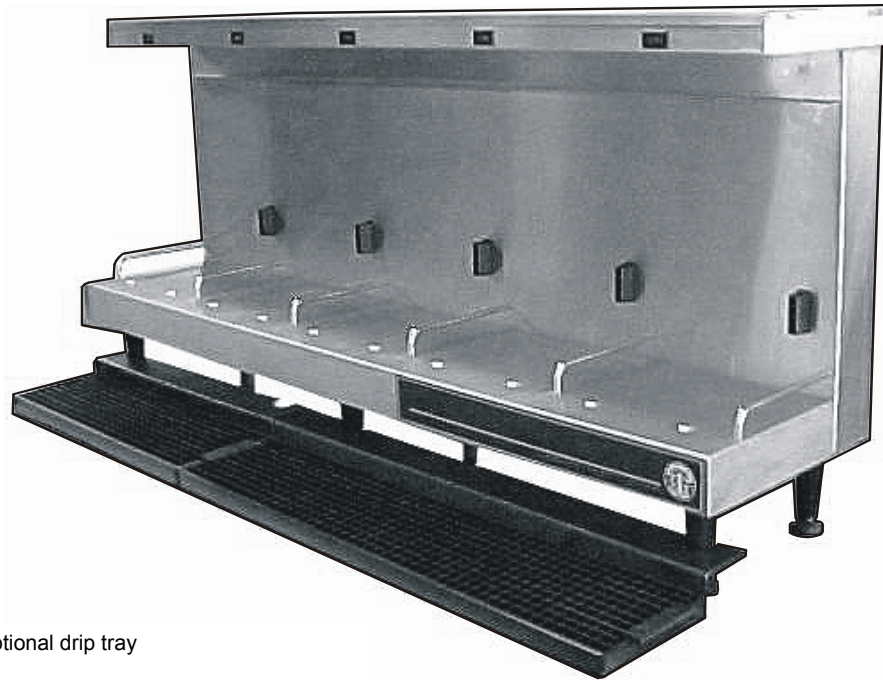

BLOOMFIELD INDUSTRIES
2 ERIK CIRCLE, P. O. Box 280
Verdi, NV 89439
Customer Service (775) 345-0444 Ext.502
fax: (775) 345-0569
www.wellsbloomfield.com

®

SDS-5SB Satellite Docking Station



Shown with optional drip tray
part no. 3905

OWNERS MANUAL

Includes

OPERATING INSTRUCTIONS
EXPLODED VIEW & PARTS LIST
INSTALLATION INSTRUCTIONS
CLEANING INSTRUCTIONS
SPECIFICATIONS
AGENCY APPROVALS

WARRANTY STATEMENT

All electrical equipment manufactured by BLOOMFIELD INDUSTRIES is warranted against defects in material and workmanship for a period of one year from original purchase or eighteen months from the date of shipment from our factory, whichever comes first, and is for the benefit of the original purchaser, except that; airpots carry a 30 day warranty only; dispensers i.e. tea and coffee carry a 90 day warranty; and, decanters are excluded.

THIS WARRANTY IS THE COMPLETE AND ONLY WARRANTY, EXPRESSED OR IMPLIED IN LAW OR IN FACT, INCLUDING, BUT NOT LIMITED TO, WARRANTIES OF MERCHANTABILITY OR FITNESS FOR ANY PARTICULAR PURPOSE, AND/OR INDIRECT OR CONSEQUENTIAL DAMAGES IN CONNECTION WITH BLOOMFIELD PRODUCTS.

This warranty is void if it is determined upon inspection by an Authorized Service Agency that the equipment has been modified, misused, misapplied, improperly installed, or damaged in transit or by fire, flood or act of God.

It also does not apply if the serial nameplate has been removed or service is performed by unauthorized personnel.

The prices charged by Bloomfield Industries for its products are based upon the limitations in this warranty. Seller's obligation under this warranty is limited to repair of defects without charge by a Bloomfield Industries Authorized Service Agency or one of its sub-agencies. This service will be provided on customer's premises for non-portable models. Portable models (a device with a cord and plug) must be taken or shipped to the closest Authorized Service Agency, transportation charges prepaid for service.

In addition to restrictions contained in this warranty, specific limitations are detailed in the *ADDITIONAL WARRANTY EXCLUSIONS* section. Bloomfield Industries Authorized Service Agencies are located in principal cities.

This warranty is valid in the United States and void elsewhere. Please consult your classified telephone directory, your food service equipment dealer, or, for information and other details concerning warranty write to:

Service Parts Department
Bloomfield Industries
P. O. Box 280

Verdi, Nevada 89439

☎ (775) 345-0444 fax (775) 345-0569

SERVICE POLICY AND PROCEDURE GUIDE ADDITIONAL WARRANTY EXCLUSIONS

1. Resetting of safety thermostats, circuit breakers, overload protectors, or fuse replacements unless warranted conditions are the cause.
2. All problems due to operation at voltages other than specified on equipment nameplates—conversion to correct voltage must be the customer's responsibility.
3. All problems due to electrical connections not made in accordance with electrical code requirements and wiring diagrams supplied with the equipment.
4. Replacement of items subject to normal wear, to include such items as knobs and light bulbs. Normal maintenance functions including adjustment of thermostats, microswitches, and replacement of fuses and indicating lights are not covered under warranty.
5. All problems due to inadequate water supply, such as fluctuating, or high or low water pressure.
6. All problems due to mineral/calcium deposits, or contamination from chlorides/chlorines. De-liming is considered a preventative maintenance function and is not covered by warranty.

7. Full use, care and maintenance instructions are supplied with each machine. Those miscellaneous adjustments noted are customer responsibility. Proper attention will prolong the life of the machine.
8. Travel mileage is limited to sixty (60) miles from an authorized Service Agency or one of its sub-agencies.
9. All labor shall be performed during normal working hours. Overtime premium shall be charged to the customer.
10. All genuine Bloomfield replacement parts are warranted for ninety (90) days from date of purchase on non-warranted equipment. **Any use of non-genuine Bloomfield parts completely voids any warranty.**
11. Installation, labor and job check-out are not considered warranty.
12. Charges incurred by delays, waiting time or operating restrictions that hinder the service technicians ability to perform services are not covered by warranty. This includes institutional and correctional facilities.

SHIPPING DAMAGE CLAIMS PROCEDURE

NOTE: For your protection, please note that equipment in this shipment was carefully inspected and packaged by skilled personnel before leaving the factory. Upon acceptance of this shipment, the transportation company assumes full responsibility for its safe delivery.

IF SHIPMENT ARRIVES DAMAGED:

1. **VISIBLE LOSS OR DAMAGE:** Be certain that any visible loss or damage is noted on the freight bill or express receipt, and that the note of loss or damage is signed by the delivery person.
2. **FILE CLAIM FOR DAMAGE IMMEDIATELY:** Regardless of the extent of the damage.

3. **CONCEALED LOSS OR DAMAGE:** if damage is unnoticed until the merchandise is unpacked, notify the transportation company or carrier immediately, and file "CONCEALED DAMAGE" claim with them. This must be done within fifteen (15) days from the date the delivery was made to you. Be sure to retain the container for inspection.

Bloomfield Industries cannot assume liability for damage or loss incurred in transit. We will, however, at your request, supply you with the necessary documents to support your claim.

TABLE OF CONTENTS

WARRANTY STATEMENT	xi
Features & Operating Controls	2
General Information & Precautions	4
Specifications (General Layout Data)	5
Installation Instructions	6
Operating instructions	8
Cleaning Instructions	9
Wiring Diagram	10
Exploded View & Parts List	11
Ordering Information / Service Procedure	12

INTRODUCTION

Thank You for purchasing this Bloomfield Industries Satellite Docking Station. The designed-in flexibility of this Satellite Docking Station will allow you to meet a wide spectrum of customer needs.

Proper installation, professional operation and consistent maintenance of this appliance will ensure that it gives you the very best performance and a long, economical service life. You will achieve maximum performance from this unit if you familiarize yourself with its many outstanding features.

Safe and satisfactory operation of this Satellite Docking Station depends to a large extent upon proper installation. This Satellite Docking Station must be installed without alteration, and in accordance with these printed instructions and with applicable electrical codes. The performance of this Docking Station can be greatly impaired if it is altered in any way, or if the installation deviates from the instructions given herein. Please be certain that electrical connections are compatible, as connection to improper voltage could damage the unit and void the warranty.

If you have any difficulties with the Docking Station, contact your nearest Bloomfield Authorized Distributor. They have the necessary expertise to provide advice and assistance. If the Bloomfield Distributor is unable to help you, please contact the factory directly

This manual contains the information needed to properly install, use and care for the Docking Station in a manner which will ensure its optimum performance.

FEATURES AND OPERATING CONTROLS

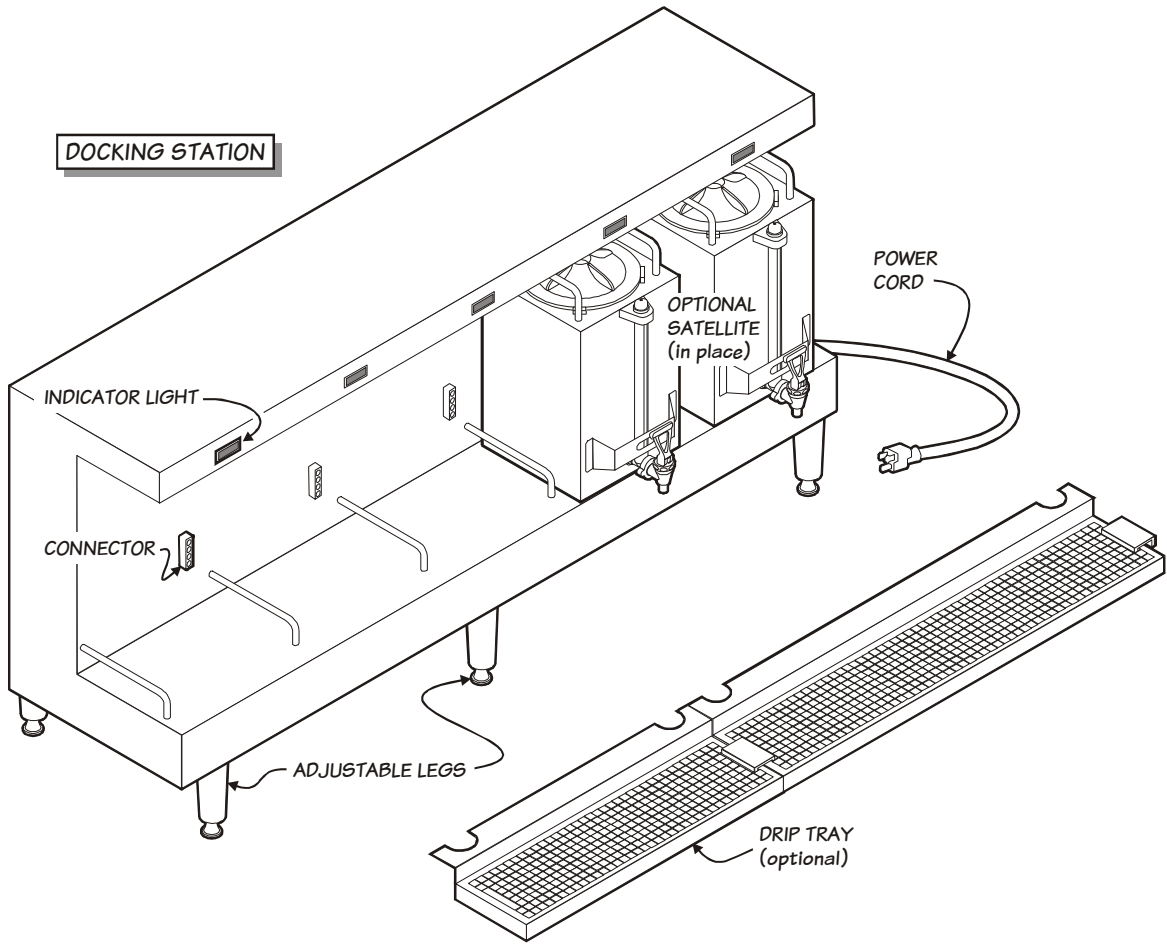

OPTIONAL SATELLITE

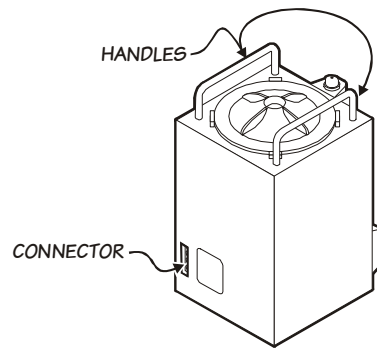

Fig 1. Satellite Docking Station Features & Operating Controls

FEATURES AND OPERATING CONTROLS (continued)

Docking Station

Adjustable Legs	Allows brewer to be leveled. Also allow clearance for cleaning underneath brewer.
Connector	Connects to satellite. Allows satellite heater to be energized. Allows brewer to sense that a satellite is in place.
Indicator Light	Glow when a satellite is properly installed at that station.
Nameplate (on back - not shown)	Lists manufacturer, model and serial number. Also lists voltage and wattage rating of brewer.
Power Cord	Allows docking station to be connected to electrical power.

(Optional) Satellite

Connector	Connects to docking station connector. Allows heater to be energized. Allows docking station to sense that a satellite is in place.
Handles	Allow the satellite to be safely carried.

(Optional) Drip Tray

Optional drip tray catches drips and spills from serving faucet. Easily removed for cleaning.

Model SDS-5SB Satellite Docking Station manufactured by Bloomfield Industries, Inc. is designed to hold coffee at a correct temperature for serving.

Operates on 120 volts, 2.0 Amps, 225 Watt service.



Safety features include the absence of any hot surfaces.

Ideal for self-service applications.

Automatic safety shut-off of electrical power to the satellite connector when a satellite is removed.

Adjustable legs with non-skid feet for easy leveling.

Teflon color coded wiring, keyed to color tabs at connection points.

  listed under E9523. Meets  Standard 4.

Satellite brewer and satellites optional.

Optional drip trays.

GENERAL INFORMATION AND PRECAUTIONS



WARNING: **Electric** **Shock hazard**

All servicing requiring access to non-insulated electrical components must be performed by a factory authorized technician.

DO NOT open any access panel which requires the use of tools. Failure to follow this warning can result in severe electrical shock.



CAUTION: **Burn Hazard**

Coffee is extremely hot. Use care when installing satellites to avoid spills or splashing. Hot coffee can cause skin burns on contact.

This appliance is intended for use in commercial establishments only.

This appliance is intended to hold specific containers of hot beverage for human consumption, and to maintain said beverage at serving temperature. No other use is recommended or authorized by the manufacturer or its agents.

Operators of this appliance must be familiar with the appliance use, limitations and associated restrictions. Operating instructions must be read and understood by all persons using or installing this appliance.

Cleanliness of this appliance is essential to good sanitation. Read and follow all included cleaning instructions and schedules to ensure the safety of the food product.

Surfaces of satellites may be hot to the touch, and may cause burns on contact.

Disconnect the docking station from electrical power before performing any maintenance or servicing.

DO NOT submerge satellites in water.

DO NOT splash or pour water over, onto or into any controls, control panel or wiring.

Any procedure which requires the use of tools must be performed by a qualified technician.

This manual is considered to be a permanent part of the appliance. This manual and all supplied instructions, diagrams, schematics, parts breakdown illustrations, notices and labels must remain with the appliance if it is sold or moved to another location.

This appliance is made in the USA. Unless otherwise noted, this appliance has American sizes on all hardware.

GENERAL LAYOUT DATA
 BLOOMFIELD SATELLITE DOCKING STATION
 MODEL: SDS-5SB

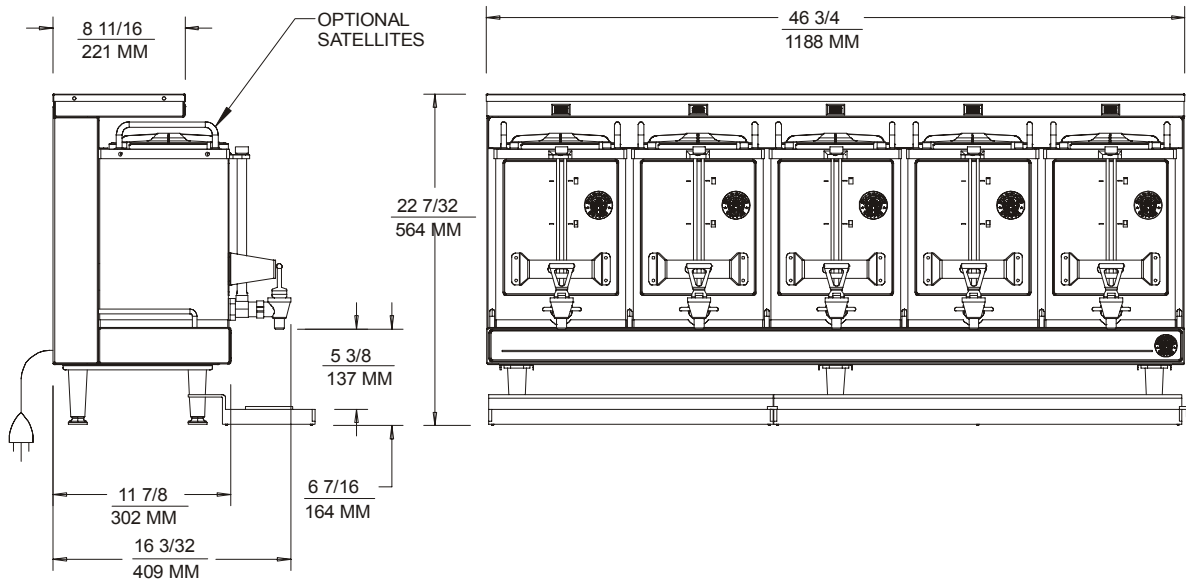
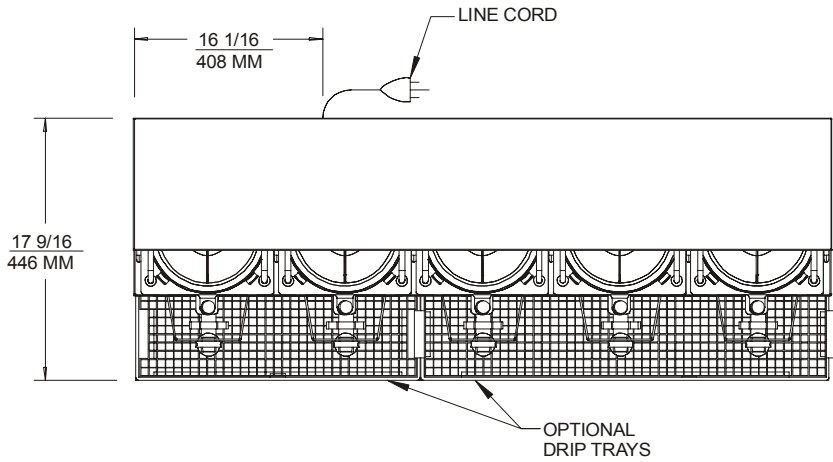

ELECTRICAL SPECIFICATIONS

MODEL	WATTS	VOLTS	AMPS
SDS-5SB	225 (with five Satellites)	120	2.0

INSTALLATION



CAUTION: DO NOT connect or energize this appliance until all Installation Instructions are read and followed. Damage to the dispenser will occur if these instructions are not followed.



WARNING: All installation procedures must be performed by a qualified technician with full knowledge of all applicable electrical and plumbing codes. Failure could result in property damage and personal injury.



WARNING: All procedures requiring access to non-insulated components must be performed by a qualified service technician.

NOTE:

To enable the installer to make a quality installation and to minimize installation time, these tests and suggestions should be completed before the actual installation is begun.

INSTALL LEGS

The brewer is provided with adjustable legs and rubber feet. Be sure the legs are securely screwed into the base of the brewer, and that the rubber feet are properly installed.

LEVEL THE UNIT

The adjustable legs allow the brewer to be leveled. Set the brewer in its ultimate operating location and check for level with a spirit level. Adjust the brewer for level from front-to-rear, and from side-to-side. Be sure all four feet rest firmly on the counter.



CAUTION: Hazard from Unstable Equipment

Rubber feet must be installed on each leg of the brewer. Legs must be adjusted so that all four feet rest firmly on the counter. Failure to properly install the feet can result in movement of the brewer, which can cause personal injury and/or damage to the brewer.

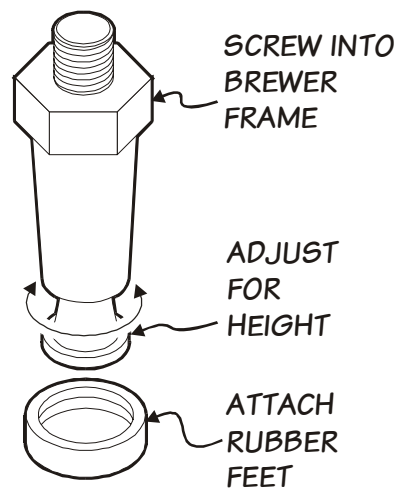

Fig. 2 Adjustable Leg

ELECTRICAL INSTALLATION INSTRUCTIONS

This unit requires a power source capable of supplying 120 Volts AC, 50/60 Hz, 3-Wire 15 Amp.

The unit is shipped from the factory with a power cord.

The power cord must be plugged into a properly grounded NEMA 5-15P receptacle.



CAUTION:
Electric Shock
Hazard

The ground prong of the electrical plug is part of a system designed to protect you in the event of equipment damage. Never cut off the large prong of the plug, nor twist a blade to fit an existing receptacle. Contact an electrician to install the proper electrical circuit and receptacle.

INITIAL SET-UP INSTRUCTIONS

Remove all satellites from the docking station. Plug power cord into an appropriate 120 volt receptacle.

Install a satellite in docking position #1. When properly installed, the indicator light will glow.

NOTE: For units equipped with quality timers, there will be a slight delay before the indicator light glows.

Repeat indicator check for positions #2 thru #5.

Docking station is ready for service.

IMPORTANT:

Initial set-up must be performed by a qualified installer or qualified service technician. Improper set-up will damage the brewer and void the warranty.

IMPORTANT:

DO NOT CONNECT POWER TO DOCKING STATION WITH SATELLITES IN PLACE.

OPERATING INSTRUCTIONS

GETTING STARTED

Check the docking station:

Check that the brewer is clean and the drip tray (if used) is empty.

Check that the docking station is plugged into an appropriate receptacle.

IMPORTANT:

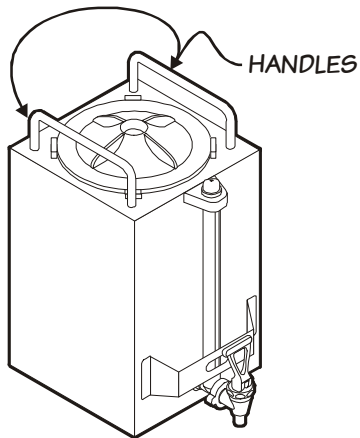

Fig. 2 Satellite Handles

DO NOT remove the satellite from the docking station by the sight glass. Always manipulate and carry the satellite by the handles at the top of the

DAILY START-UP

Install satellites in any or all of the five positions of the docking station. When the satellite is properly installed, the connector of the satellite will be fully seated in the connector of the docking station, and the indicator light for that docking position will glow.

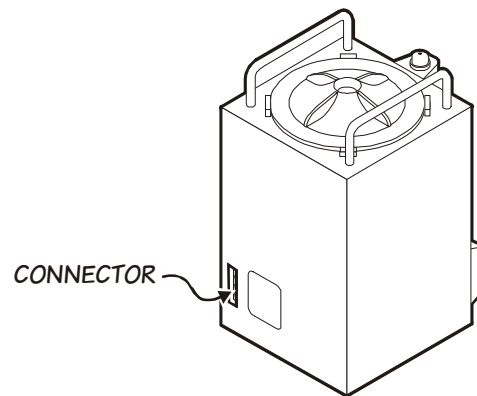

Fig. 3 Satellite Connector

CLEANING INSTRUCTIONS

PROCEDURE: Clean Satellite Docking Station

PRECAUTIONS: Unplug docking station
Remove satellites

FREQUENCY: Daily

TOOLS: Mild Detergent, Clean Soft Cloth or Sponge

1. Unplug docking station from electrical power.
2. Remove satellites.
3. Remove and drain the drip tray. Rinse in a sink under warm running water. Allow to air dry, then reinstall on brewer.
4. Wipe exterior of docking station with a soft clean cloth or sponge moistened with clean water.
5. Reinstall satellites.

Procedure is complete



CAUTION: Burn Hazard

Serving temperatures of coffee is extremely hot. Hot coffee will cause serious skin burns.

WARNING:



Electric Shock Hazard

DO NOT immerse or submerge satellites. Fluid may saturate the insulation and short-circuit the receptacle connectors. Electric shock may cause injury and property damage.

IMPORTANT:

DO NOT use steel wool sharp objects, or caustic, abrasive or chlorinated cleansers to clean the docking station or satellites.

WIRING DIAGRAM

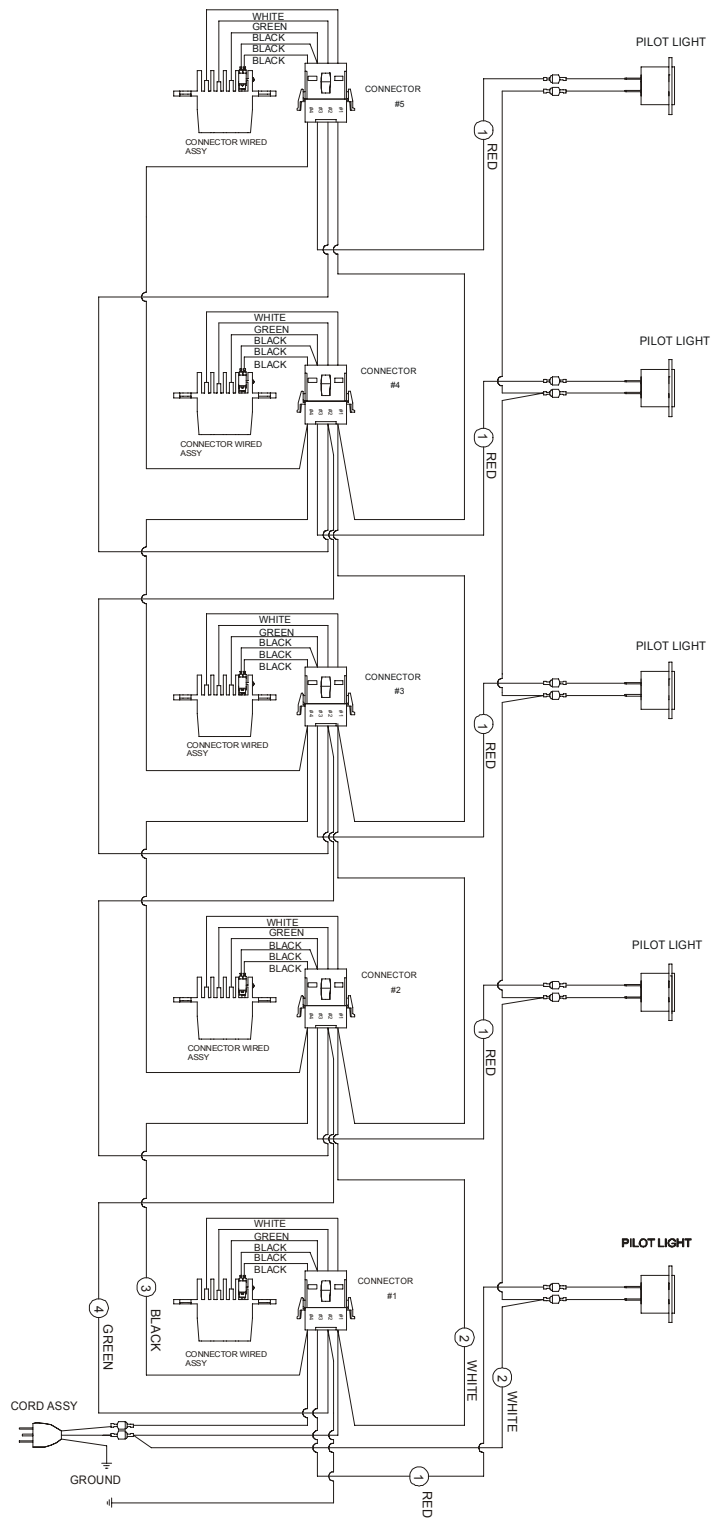

MODEL:	VOLTS:	WATTS:
SDS-5SB	120	220 W (USE WITH [5] SATELLITES)

EXPLODED VIEW & PARTS LIST

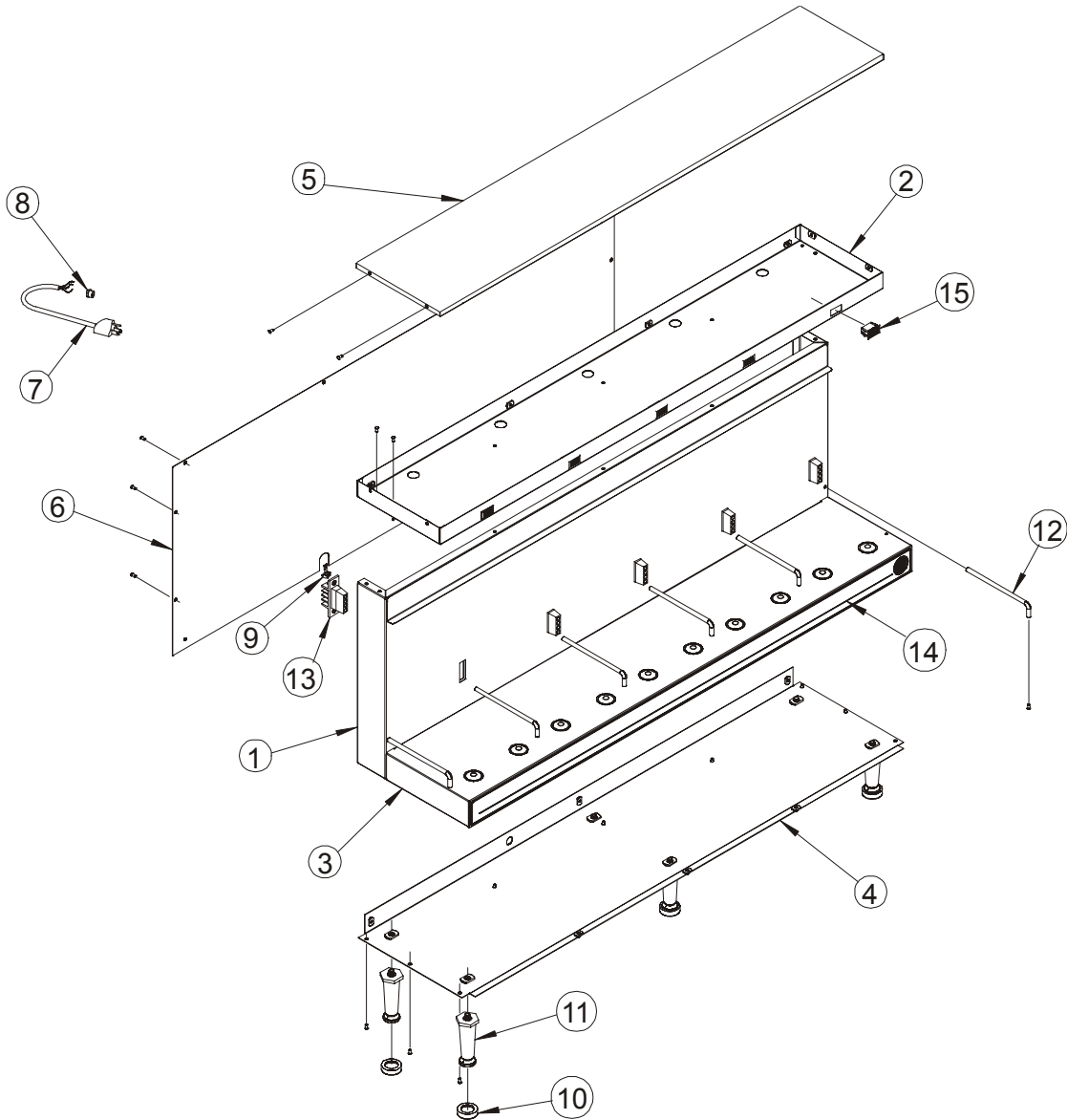

ITEM	SERVICE #	DESCRIPTION	QTY.
1	75177	WELD ASSY BODY	1
2	75176	ASSY TOP HOUSING	1
3	75180	WELD ASSY BASE	1
4	75175	WELD ASSY BOTTOM PLATE	1
5	75182	LID	1
6	75181	BACK PANEL	1
7	6407-15	CORD ASSY	1
8	35-210	STRAIN RELIEF	1
9	83105	SWITCH WITH SCREWS	1
10	83107	FEET, RUBBER, BLACK	4
11	83098	LEG, 4" BLACK, W/FLANGED FOOT	4
12	83077	HANDLE GUIDE "L"	6
13	83046	CONNECTOR ASSY	5
14	75185	LABEL, BASE	1
15	84784	ASSY LIGHT GREEN 250V	5

ACCESSORIES (not shown)

SERVICE #	DESCRIPTION	QTY.
3901	DRIP TRAY	1
3903	DRIP TRAY, SDS-5	1

EXPLODED VIEW & PARTS LIST

(MODEL: SDS-5SB)

ORDERING / SERVICE PROCEDURES

Use only genuine Bloomfield replacement parts in this brewer. The use of replacement parts other than those supplied by Bloomfield voids the warranty.

Parts are available at your Authorized Bloomfield Service Agency. Locations and phone numbers are listed in the Agency Listing provided with all equipment.

To find the parts required to restore proper operation to the coffee brewer, proceed as follows:

1. Refer to the exploded views located in this manual to identify the parts needed.
2. Use the item number from the exploded view to locate the corresponding part number in the parts identification and function of this manual.

Ordering Information - Once the parts needed are known, record the following information from the Identification Name Plate on the side of the Unit and

Model: Serial Number:

Part No.	Description	Qty	Part No.	Description	Qty
<input type="text"/>	<input type="text"/>	<input type="text"/>	<input type="text"/>	<input type="text"/>	<input type="text"/>
<input type="text"/>	<input type="text"/>	<input type="text"/>	<input type="text"/>	<input type="text"/>	<input type="text"/>
<input type="text"/>	<input type="text"/>	<input type="text"/>	<input type="text"/>	<input type="text"/>	<input type="text"/>
<input type="text"/>	<input type="text"/>	<input type="text"/>	<input type="text"/>	<input type="text"/>	<input type="text"/>
<input type="text"/>	<input type="text"/>	<input type="text"/>	<input type="text"/>	<input type="text"/>	<input type="text"/>
<input type="text"/>	<input type="text"/>	<input type="text"/>	<input type="text"/>	<input type="text"/>	<input type="text"/>
<input type="text"/>	<input type="text"/>	<input type="text"/>	<input type="text"/>	<input type="text"/>	<input type="text"/>
<input type="text"/>	<input type="text"/>	<input type="text"/>	<input type="text"/>	<input type="text"/>	<input type="text"/>
<input type="text"/>	<input type="text"/>	<input type="text"/>	<input type="text"/>	<input type="text"/>	<input type="text"/>
<input type="text"/>	<input type="text"/>	<input type="text"/>	<input type="text"/>	<input type="text"/>	<input type="text"/>
<input type="text"/>	<input type="text"/>	<input type="text"/>	<input type="text"/>	<input type="text"/>	<input type="text"/>
<input type="text"/>	<input type="text"/>	<input type="text"/>	<input type="text"/>	<input type="text"/>	<input type="text"/>
<input type="text"/>	<input type="text"/>	<input type="text"/>	<input type="text"/>	<input type="text"/>	<input type="text"/>
<input type="text"/>	<input type="text"/>	<input type="text"/>	<input type="text"/>	<input type="text"/>	<input type="text"/>
<input type="text"/>	<input type="text"/>	<input type="text"/>	<input type="text"/>	<input type="text"/>	<input type="text"/>

How to order - For immediate shipment, call your local BLOOMFIELD INDUSTRIES Authorized Service Agency.

Service Information - To obtain service assistance in addition to that contained in this chapter, call BLOOMFIELD in the U.S. at (775) 345-0444 or email at service@wellsbloofield.com.

Be prepared to give the model and serial numbers of your brewer, as well as the problem and the troubleshooting steps already taken, to the service technician when calling for assistance.

For best results, use only genuine Bloomfield paper filters in this brewer.

IMPORTANT: Use only factory authorized service parts.

For factory authorized service, or to order factory authorized replacement parts, contact your Authorized Bloomfield Distributor, or call:

Bloomfield Industries Co.

2 Erik Circle

P. O. Box 280

Verdi, NV 89439

phone: (775) 345-0444 fax: (888) 492-2783

(Service Parts Dept.)

Service Parts Department can supply you with the name and telephone number of the AUTHORIZED BLOOMFIELD DISTRIBUTOR nearest you.



Bloomfield Industries, Inc.

PO. Box 280 Verdi, NV. 89439
Ph. 775/345-0444 Fax 888/492-2783
Service: 1-888/492-2783
website: www.wellsbloomfield.com

Bloomfield Industries Canada Limited

5850 Keaton Crescent
Mississauga, Ontario, Canada L5R 3K2
Ph. 905/507-1700 Fax 905/507-1777
Toll Free 1-877-507-1700
website: www.bloomcan.com
e-mail: brewinfo@bloomcan.com



Carrier

A United Technologies Company